



Since 1987

# No. 1. Oil Mist Collector Mist Cleaner



## Function 1

98% efficiency for 1 $\mu$ m

## Function 2

Nozzle for cleaning of Fan & Filter

## Function 3

Available to check direction of Fan's rotation

## Function 4

Motor's running check lamp

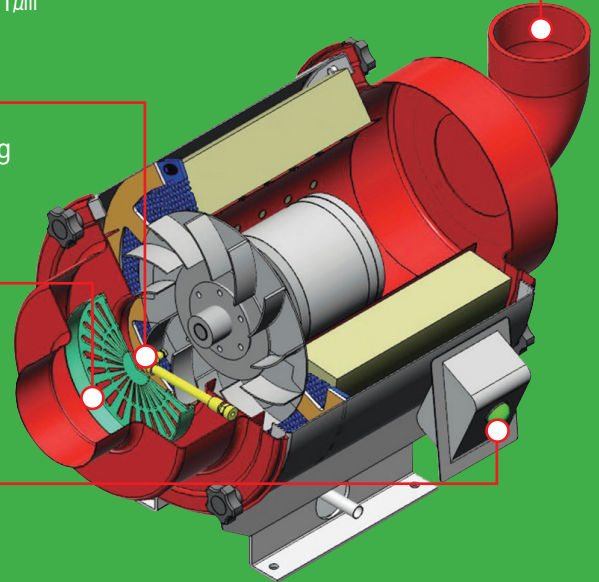

A collector with no filter replacement

 **YHB ECO CO.,LTD**

# YHB ECO Global Network



## YHB ECO References

<p>20,000 units to Samsung (Vietnam) in 2014</p>	<p>2,000 units to LG (China) in 2017</p>
--	--

## Why YHB ECO MIST CLEANER

<p>PERFECT QUALITY</p>	<p>OCCUPATIONAL DISEASE PREVENTION</p>	<p>CONTINUOUS INNOVATION</p>
------------------------	--	------------------------------

## APPLICATION

Machining Center	CNC Lathe tapping machine	Milling machine	EDM, etc.
------------------	---------------------------	-----------------	-----------

## CERTIFICATION

# YHB ECO MIST CLEANER PRODUCT LINE UP

## YMC TYPE Water-soluble lubricant

### YMC TYPE



- Standard model
- Sales No. 1.

### YMC A-TYPE(Patented New Model)



- Cleaning Fan&Body
- Reducing Maintenance Cost
- Maintaining High Efficiency

### YMC C-TYPE



- Demister Filter
- Available to Reuse Filter
- Reducing Maintenance Cost

### YMC F-TYPE



- Attached Filter Service Indicator
- Maintaining High Efficiency
- Available to Check Filter Condition

\* Available YMC CA, FA, FC, FCA type

## YOC TYPE Oil lubricant

### YOC TYPE



- Chip Separator
- Collecting Chip and Mist

### YOC A-TYPE



- Chip Separator
- Cleaning Fan&Body
- Reducing Maintenance Cost
- Maintaining High Efficiency

### YOC C-TYPE



- Chip Separator
- Demister Filter
- Available to Reuse Filter
- Reducing Maintenance Cost

### YOC F-TYPE



- Chip Separator
- Attached Filter Service Indicator
- Available to Check Filter Condition
- Maintaining High Efficiency

\* Available YOC CA, FA, FC, FCA type

# MIST CLEANER YMC type (Water-soluble lubricant)



## FEATURES

- Centrifugal Force Technology and Filters (98% collection rate for 1µm)
- Standard model(Sales No. 1.)
- 20,000 units to Samsung(Vietnam) in 2014
- 2,000 units to LG(China) in 2017



## SPECIFICATIONS & DIMENSIONS

MODEL	YMC-300	YMC-350	YMC-400	YMC-420
POWER	3 Phase 220V / 380V / 440V (50/60Hz)			
Motor(Kw)	0.4	0.75	1.5	2.2
Ampere(A)	1.7 / 1.0 / 0.8	3.5 / 2.0 / 1.6	6.5 / 3.7 / 3.3	8.5 / 4.9 / 4.2
RPM	3,450			
Wind Flow Rate(m³/min)	7	12	25	30
Static Pressure(mmAq)	90	120	170	180
Noise(dB)	65±2	68±2	70±2	70±2
Collection Rate(%)	98% for 1µm			
Inlet, Outlet(ø)	100	125	150	150
Weight(kg)	25	33	55	59
Filter Material	POLYESTER			

※ When After Filter is mounted, wind flow rate will be decreased by 8%  
 ※ Above specifications are based on 60Hz, When applying 50Hz air volume is reduced by 20%.

Unit : mm

MODEL	A	B	C	D	E	F	G	H	I	J
YMC-300	320	409	180	220	210	240	ø100	322	680	188
YMC-350	365	454	180	220	210	240	ø125	370	800	222
YMC-400	452	595	280	320	360	400	ø150	480	973	235
YMC-420										

After Filter(option)

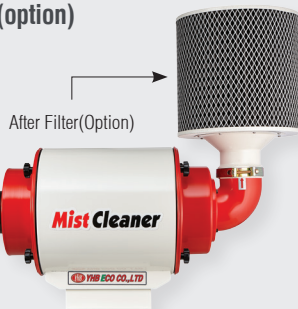

## AFTER FILTER

MODEL	YMC-300	YMC-350	YMC-400	YMC-420
D	ø 350	ø 350	ø 350	ø 350
H	330	330	500	500

STANDARD PARTS	OPTION PARTS
1. DRAIN HOSE : 3m 2. FLANGE : 1EA	1. AFTER FILTER

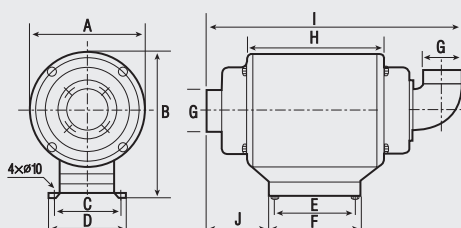

# MIST CLEANER YOC type (Oil lubricant)



## FEATURES

- Chip Separator(with Glass Filter)
- Collecting Chip and Mist
- Oil lubricant



## SPECIFICATIONS & DIMENSIONS

MODEL	YOC-300	YOC-350	YOC-400	YOC-420
POWER	3 Phase 220V / 380V / 440V (50/60Hz)			
Motor(Kw)	0.4	0.75	1.5	2.2
Ampere(A)	1.7 / 1.0 / 0.8	3.5/2.0/1.6	6.5/3.7/3.3	8.5/4.9/4.2
RPM	3,450			
Wind Flow Rate(m <sup>3</sup> /min)	5	10	20	25
Static Pressure(mmAq)	90	120	170	180
Noise(dB)	65±2	68±2	70±2	70±2
Collection Rate(%)	98% for 1µm			
Inlet, Outlet(ø)	100	125	150	150
Weight(kg)	30	37	64	67
Filter Material	POLYESTER			

※ When After Filter is mounted, wind flow rate will be decreased by 8%  
 ※ Above specifications are based on 60Hz, When applying 50Hz air volume is reduced by 20%.

Unit : mm

MODEL	A	B	C	D	E	F	G	H	I	J
YOC-300	320	409	180	220	210	240	ø100	322	800	275
YOC-350	365	454	180	220	210	240	ø125	370	895	345
YOC-400	452	595	280	320	360	400	ø150	480	1,058	379
YOC-420										

## AFTER FILTER

MODEL	YOC-300	YOC-350	YOC-400	YOC-420
D	ø 350	ø 350	ø 350	ø 350
H	330	330	500	500

STANDARD PARTS	OPTION PARTS
1. DRAIN HOSE : 3m x 2ea 2. FLANGE : 1EA	1. AFTER FILTER

### After Filter(option)

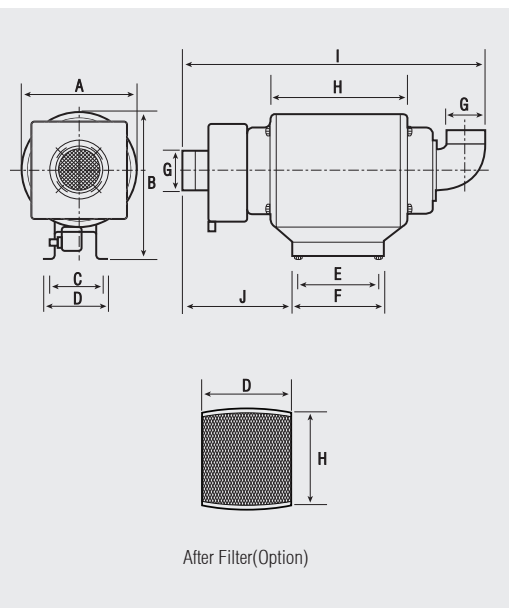
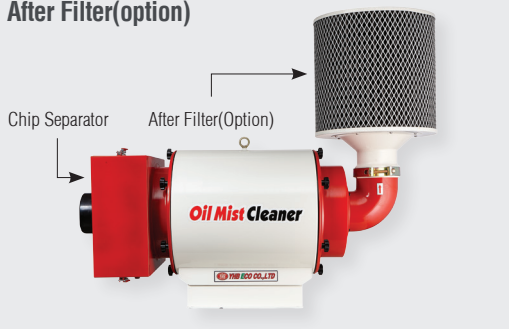

# MIST CLEANER YMC A-type (Water-soluble lubricant)

**new**



## FEATURES

- Patented New Model
- Cleaning Fan&Body
- Reducing Maintenance Cost
- Maintaining High Efficiency



## SPECIFICATIONS & DIMENSIONS

MODEL	YMC-300A	YMC-350A	YMC-400A	YMC-420A
POWER	3 Phase 220V / 380V / 440V (50/60Hz)			
Motor(Kw)	0.4	0.75	1.5	2.2
Ampere(A)	1.7 / 1.0 / 0.8	3.5 / 2.0 / 1.6	6.5 / 3.7 / 3.3	8.5 / 4.9 / 4.2
RPM	3,450			
Wind Flow Rate(m <sup>3</sup> /min)	7	12	25	30
Static Pressure(mmAq)	90	120	170	180
Noise(dB)	65±2	68±2	70±2	70±2
Collection Rate(%)	98% for 1µm			
Inlet, Outlet(ø)	100	125	150	150
Weight(kg)	25	33	55	59
Filter Material	POLYESTER			

※ When After Filter is mounted, wind flow rate will be decreased by 8%  
 ※ Above specifications are based on 60Hz, When applying 50Hz air volume is reduced by 20%.

Unit : mm

MODEL	A	B	C	D	E	F	G	H	I	J
YMC-300A	320	409	180	220	210	240	ø100	322	680	188
YMC-350A	365	454	180	220	210	240	ø125	370	800	222
YMC-400A	452	595	280	320	360	400	ø150	480	973	235
YMC-420A										

After Filter(option)



\* Wash once a month for 5 minutes

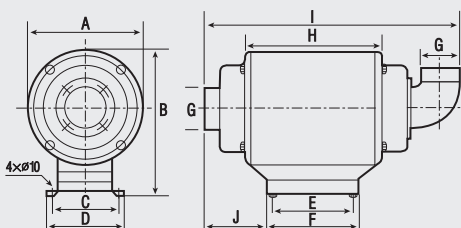

## AFTER FILTER

MODEL	YMC-300A	YMC-350A	YMC-400A	YMC-420A
D	ø 350	ø 350	ø 350	ø 350
H	330	330	500	500

STANDARD PARTS	OPTION PARTS
1. DRAIN HOSE : 3m 2. FLANGE : 1EA	1. AFTER FILTER

# MIST CLEANER YOC A-type (Oil lubricant)



## FEATURES

- Chip Separator
- Cleaning Fan&Body
- Reducing Maintenance Cost
- Maintaining High Efficiency



## SPECIFICATIONS & DIMENSIONS

MODEL	YOC-300A	YOC-350A	YOC-400A	YOC-420A
POWER	3 Phase 220V / 380V / 440V (50/60Hz)			
Motor(Kw)	0.4	0.75	1.5	2.2
Ampere(A)	1.7 / 1.0 / 0.8	3.5 / 2.0 / 1.6	6.5 / 3.7 / 3.3	8.5 / 4.9 / 4.2
RPM	3,450			
Wind Flow Rate(m <sup>3</sup> /min)	5	10	20	25
Static Pressure(mmAq)	90	120	170	180
Noise(dB)	65±2	68±2	70±2	70±2
Collection Rate(%)	98% for 1μm			
Inlet, Outlet(ø)	100	125	150	150
Weight(kg)	30	37	64	67
Filter Material	POLYESTER			

※ When After Filter is mounted, wind flow rate will be decreased by 8%  
 ※ Above specifications are based on 60Hz, When applying 50Hz air volume is reduced by 20%.

Unit : mm

MODEL	A	B	C	D	E	F	G	H	I	J
YOC-300A	320	409	180	220	210	240	ø100	322	800	275
YOC-350A	365	454	180	220	210	240	ø125	370	895	345
YOC-400A	452	595	280	320	360	400	ø150	480	1,058	379
YOC-420A										

### After Filter(option)

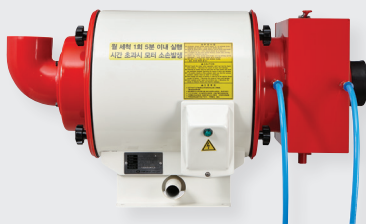

\* Wash once a month for 5 minutes

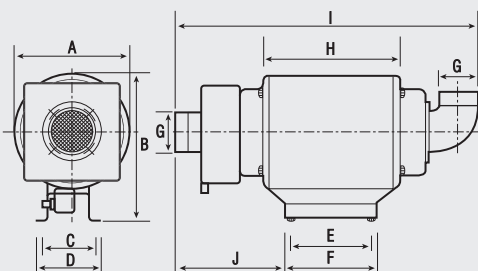

## AFTER FILTER

MODEL	YOC-300A	YOC-350A	YOC-400A	YOC-420A
D	ø 350	ø 350	ø 350	ø 350
H	330	330	500	500

STANDARD PARTS	OPTION PARTS
1. DRAIN HOSE : 3m x 2ea 2. FLANGE : 1EA	1. AFTER FILTER

# MIST CLEANER YMC C-type (Water-soluble lubricant)



## FEATURES

- Demister Filter(95% collection rate)
- Available to Reuse Filter
- Reducing Maintenance Cost



## SPECIFICATIONS & DIMENSIONS

MODEL	YMC-300C	YMC-350C	YMC-400C	YMC-420C
POWER	3 Phase 220V / 380V / 440V (50/60Hz)			
Motor(Kw)	0.4	0.75	1.5	2.2
Ampere(A)	1.7 / 1.0 / 0.8	3.5 / 2.0 / 1.6	6.5 / 3.7 / 3.3	8.5 / 4.9 / 4.2
RPM	3,450			
Wind Flow Rate(m <sup>3</sup> /min)	7	12	25	30
Static Pressure(mmAq)	90	120	170	180
Noise(dB)	65±2	68±2	70±2	70±2
Collection Rate(%)	95% for 2μm			
Inlet, Outlet(ø)	100	125	150	150
Weight(kg)	25	33	55	59
Filter Material	DEMISTER			

※ When After Filter is mounted, wind flow rate will be decreased by 8%  
 ※ Above specifications are based on 60Hz, When applying 50Hz air volume is reduced by 20%.

Unit : mm

MODEL	A	B	C	D	E	F	G	H	I	J
YMC-300C	320	409	180	220	210	240	ø100	322	680	188
YMC-350C	365	454	180	220	210	240	ø125	370	800	222
YMC-400C	452	595	280	320	360	400	ø150	480	973	235
YMC-420C										

### After Filter(option)

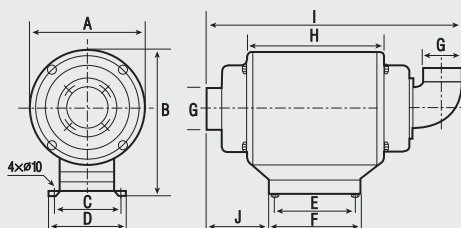

## AFTER FILTER

MODEL	YMC-300C	YMC-350C	YMC-400C	YMC-420C
D	ø 350	ø 350	ø 350	ø 350
H	330	330	500	500

STANDARD PARTS	OPTION PARTS
1. DRAIN HOSE : 3m 2. FLANGE : 1EA	1. AFTER FILTER



# MIST CLEANER YOC C-type (Oil lubricant)



## FEATURES

- Chip Separator
- Demister Filter(95% collection rate)
- Available to Reuse Filter
- Reducing Maintenance Cost



## SPECIFICATIONS & DIMENSIONS

MODEL	YOC-300C	YOC-350C	YOC-400C	YOC-420C
POWER	3 Phase 220V / 380V / 440V (50/60Hz)			
Motor(Kw)	0.4	0.75	1.5	2.2
Ampere(A)	1.7 / 1.0 / 0.8	3.5 / 2.0 / 1.6	6.5 / 3.7 / 3.3	8.5 / 4.9 / 4.2
RPM	3,450			
Wind Flow Rate(m <sup>3</sup> /min)	5	10	20	25
Static Pressure(mmAq)	90	120	170	180
Noise(dB)	65±2	68±2	70±2	70±2
Collection Rate(%)	95% for 2µm			
Inlet, Outlet(ø)	100	125	150	150
Weight(kg)	30	37	64	67
Filter Material	DEMISTER			

※ When After Filter is mounted, wind flow rate will be decreased by 8%  
 ※ Above specifications are based on 60Hz, When applying 50Hz air volume is reduced by 20%.

Unit : mm

MODEL	A	B	C	D	E	F	G	H	I	J
YOC-300C	320	409	180	220	210	240	ø100	322	800	275
YOC-350C	365	454	180	220	210	240	ø125	370	895	345
YOC-400C	452	595	280	320	360	400	ø150	480	1,058	379
YOC-420C										

## AFTER FILTER

MODEL	YOC-300C	YOC-350C	YOC-400C	YOC-420C
D	ø 350	ø 350	ø 350	ø 350
H	330	330	500	500

STANDARD PARTS	OPTION PARTS
1. DRAIN HOSE : 3m x 2ea 2. FLANGE : 1EA	1. AFTER FILTER

### After Filter(option)

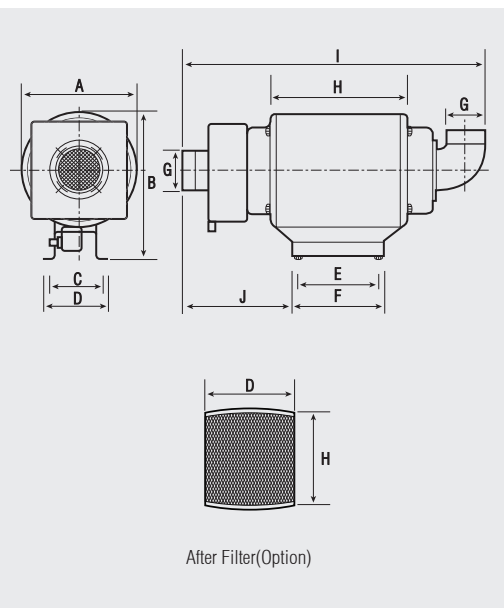

# MIST CLEANER YMC F-type (Water-soluble lubricant)



## FEATURES

- Attached Filter Service Indicator
- Available to Check Filter Condition
- Maintaining High Efficiency



## SPECIFICATIONS & DIMENSIONS

MODEL	YMC-300F	YMC-350F	YMC-400F	YMC-420F
POWER	3 Phase 220V / 380V / 440V (50/60Hz)			
Motor(Kw)	0.4	0.75	1.5	2.2
Ampere(A)	1.7 / 1.0 / 0.8	3.5 / 2.0 / 1.6	6.5 / 3.7 / 3.3	8.5 / 4.9 / 4.2
RPM	3,450			
Wind Flow Rate(m <sup>3</sup> /min)	7	12	25	30
Static Pressure(mmAq)	90	120	170	180
Noise(dB)	65±2	68±2	70±2	70±2
Collection Rate(%)	98% for 1µm			
Inlet, Outlet(ø)	100	125	150	150
Weight(kg)	25	33	55	59
Filter Material	POLYESTER			

※ When After Filter is mounted, wind flow rate will be decreased by 8%  
 ※ Above specifications are based on 60Hz, When applying 50Hz air volume is reduced by 20%.

Unit : mm

MODEL	A	B	C	D	E	F	G	H	I	J
YMC-300F	320	409	180	220	210	240	ø100	322	680	188
YMC-350F	365	454	180	220	210	240	ø125	370	800	222
YMC-400F	452	595	280	320	360	400	ø150	480	973	235
YMC-420F										

### After Filter(option)

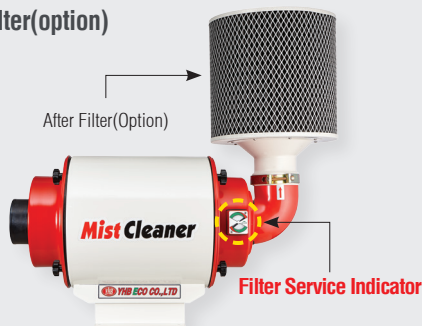

## AFTER FILTER

MODEL	YMC-300F	YMC-350F	YMC-400F	YMC-420F
D	ø 350	ø 350	ø 350	ø 350
H	330	330	500	500

STANDARD PARTS	OPTION PARTS
1. DRAIN HOSE : 3m 2. FLANGE : 1EA	1. AFTER FILTER

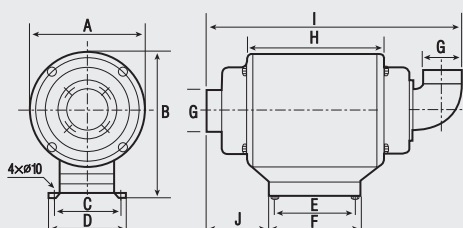

# MIST CLEANER YOC F-type (Oil lubricant)



## FEATURES

- Chip Separator
- Attached Filter Service Indicator
- Available to Check Filter Condition
- Maintaining High Efficiency



## SPECIFICATIONS & DIMENSIONS



MODEL	YOC-300F	YOC-350F	YOC-400F	YOC-420F
POWER	3 Phase 220V / 380V / 440V (50/60Hz)			
Motor(Kw)	0.4	0.75	1.5	2.2
Ampere(A)	1.7 / 1.0 / 0.8	3.5 / 2.0 / 1.6	6.5 / 3.7 / 3.3	8.5 / 4.9 / 4.2
RPM	3,450			
Wind Flow Rate(m <sup>3</sup> /min)	5	10	20	25
Static Pressure(mmAq)	90	120	170	180
Noise(dB)	65±2	68±2	70±2	70±2
Collection Rate(%)	98% for 1μm			
Inlet, Outlet(ø)	100	125	150	150
Weight(kg)	30	37	64	67
Filter Material	POLYESTER			

※ When After Filter is mounted, wind flow rate will be decreased by 8%  
 ※ Above specifications are based on 60Hz, When applying 50Hz air volume is reduced by 20%.

Unit : mm

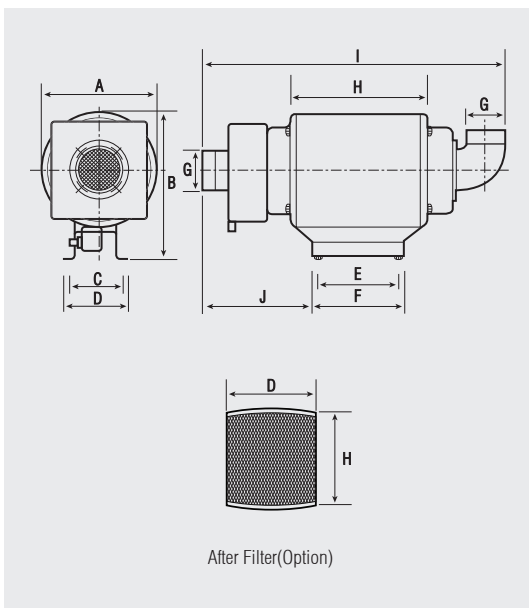

MODEL	A	B	C	D	E	F	G	H	I	J
YOC-300F	320	409	180	220	210	240	ø100	322	800	275
YOC-350F	365	454	180	220	210	240	ø125	370	895	345
YOC-400F	452	595	280	320	360	400	ø150	480	1,058	379
YOC-420F										

## AFTER FILTER

MODEL	YOC-300F	YOC-350F	YOC-400F	YOC-420F
D	ø 350	ø 350	ø 350	ø 350
H	330	330	500	500

STANDARD PARTS	OPTION PARTS
1. DRAIN HOSE : 3m x 2ea 2. FLANGE : 1EA	1. AFTER FILTER

A collector with no filter replacement

## **YHB ECO CO., LTD**

### Head Office

Rm501, 14, Gasandigital2-ro, Geumcheon-gu, Seoul, Korea  
T. 82-2-2029-6400 F. 82-2-2029-6404  
Web. [www.yhbeco.com/en](http://www.yhbeco.com/en)  
E-mail. [info@yhb.co.kr](mailto:info@yhb.co.kr)

### Gwangju Factory

45, Hanamsandan 5beon-ro, Gwangsan-gu, Gwangju, KOREA  
T. 82-62-953-2995 F. 82-62-953-2998

### Iksan Factory

41, Seokam 1 Iksan Jeonbok, KOREA  
T. 82-63-835-4771, F. 82-63-835-4776  
[www.yhbeco.com](http://www.yhbeco.com)

A collector with no filter replacement

## **YHB CO., LTD**

### Factory

74, Hanamsandan 7beon-ro, Gwangsan-gu, Gwangju, KOREA  
T. 82-62-952-6633, F. 82-62-952-6635

### Seoul Office

14, Gasan digital 2-ro, Geumcheon-gu, Seoul, KOREA  
Daerung-technotown 12-501 ho  
T. 82-2-2029-6400-3, 82-31-430-6633  
F. 82-2-2029-6404  
E-mail. [yhbcom@hanmail.net](mailto:yhbcom@hanmail.net)

### Technical Research Center

107, Hanamsandan 9beon-ro, Gwangsan-gu, Gwangju, KOREA  
T. 82-62-351-6633, F. 82-62-351-6633  
[www.yhb.co.kr](http://www.yhb.co.kr)

A collector with no filter replacement

## **CHINA EXCLUSIVE DISTRIBUTOR**

TIANJIN TAIJING GODE AUTOMATION TECHNOLOGY CO., LTD  
#2-301, BLOCK C, NO. 28, HAITAI SOUTH ROAD,  
HUAYUAN INDUSTRIAL DISTRICT, TIANJIN, CHINA, POST: 300-392  
T. 86-22-83750103/83750104, F. 86-22-83750105  
E-mail. [taijing@tj-taijing.com](mailto:taijing@tj-taijing.com)

A collector with no filter replacement

## **JAPAN EXCLUSIVE DISTRIBUTOR**

SANKYO SEIKI CO., LTD  
49 Kujo-cho, Kisshoin Minami-Ku,  
Kyoto 601-8328, Japan, POST: 601-8328  
TEL: 81-75-681-5713 FAX: 81-75-672-5430  
Web. [www.sankyo-seiki.com](http://www.sankyo-seiki.com)



**Always Clean Workplace**

2018. 09

